

ROLL

COUNTERSUNK HEAD STAR

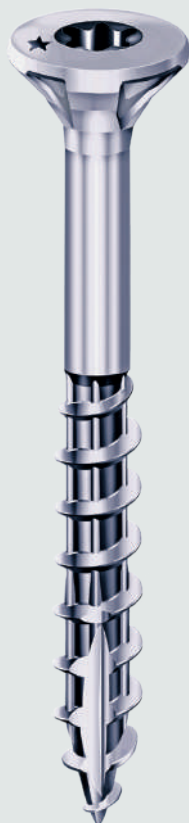

T

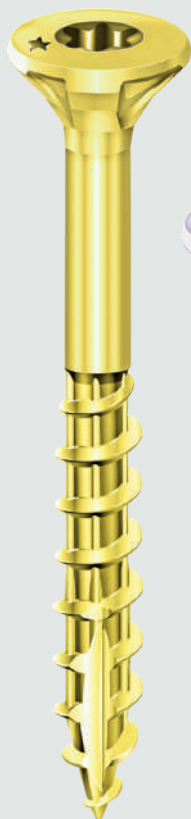
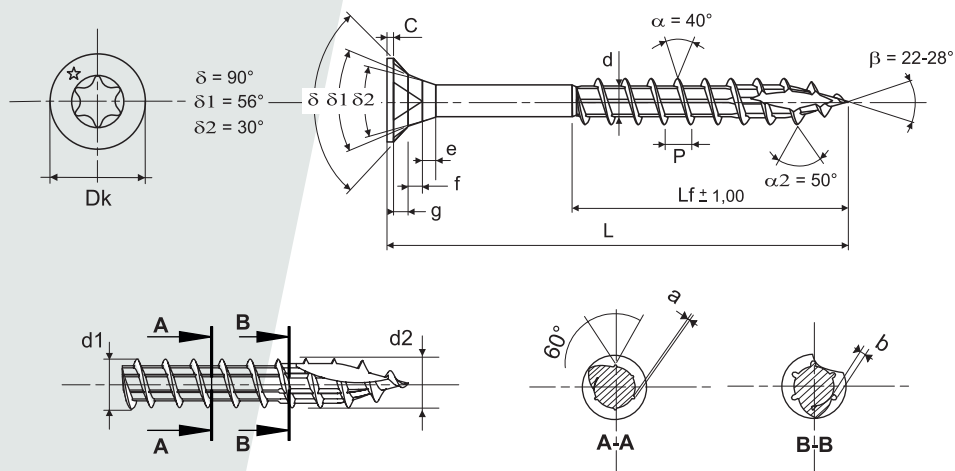

TECHNICAL CHARACTERISTICS (Bichromate steel)

	Ø 4	Ø 4,5	Ø 5
Head depth	1,40 / 1,70	1,80 / 2,10	2,10 / 2,40
Screw driver	T20	T20	T25
Dk	7,70 ± 0,20	8,70 ± 0,20	9,30 ± 0,20
C	0,40 / 0,70	0,50 / 0,80	0,60 / 0,90
g	1,45	1,60	1,63
f	1,35	1,50	1,60
e	1,25	1,39	1,50
d	2,30 / 2,60	2,50 / 2,80	2,90 / 3,30
P	2,30 ± 10%	2,60 ± 10%	2,90 ± 10%
d1	3,95	4,45	4,95
d2	4,05	4,55	5,05
a/b	0,22 / 0,32	0,22 / 0,37	0,22 / 0,42
Minimum breaking torque	3,90 Nm	5,00 Nm	7,00 Nm



EN 14592
+A1 2012

All Ø L = 35/55 60/80

Tolerance 0/-1,25 0 / -1,50

\ Bichromate steel - A2 stainless steel